





Nestled on Garthome Avenue in the sought-after west end of Darlington, this modern semi-detached bungalow presents an excellent opportunity for those seeking a comfortable and convenient home.

The bungalow boasts two well-proportioned bedrooms, each equipped with fitted wardrobes, ensuring ample storage space. Also having a modern shower room with a WC, providing practicality for everyone.

The fitted kitchen is designed for functionality, and the living/dining room offers a welcoming atmosphere, seamlessly flowing into a conservatory that invites natural light and provides a lovely space to enjoy the garden views.

Outside, the property features a generous block-paved driveway that accommodates parking for several vehicles, along with a garage for additional storage or for a vehicle.

Situated in a desirable area, this bungalow is conveniently located near local shopping facilities, making daily errands a breeze. With its appealing features and prime location, this property is sure to attract interest from those looking for a delightful home in Darlington.







- No onward chain
- Popular West End location
- Walking distance to Mowden Shopping facilities
- Large living room
- Good sized conservatory
- Large block paved driveway leading to garage
- Suited to a variety of buyers
- Bungalows in the West End are always in demand

#### **Buyers Identification Checks**

Should a purchaser(s) have an offer accepted on a property marketed by Carver Residential they will need to undertake an identification check. This is done to meet our obligation under Anti Money Laundering Regulations (AML) and is a legal requirement. We use a specialist third party service to verify your identity, this is not a credit check and will have no effect on credit history. The cost of these checks is £36 inc. VAT per buyer, which is paid in advance, when an offer is agreed and prior to a sales memorandum being issued. This charge is non-refundable.

#### **GENERAL INFORMATION**

Tenure: Freehold

Services: Gas central heating, mains electric, water and drainage.  
Double glazing

Local Authority: Darlington Borough Council (Tax Banding C)

# Ground Floor

Approx. 82.5 sq. metres (888.2 sq. feet)

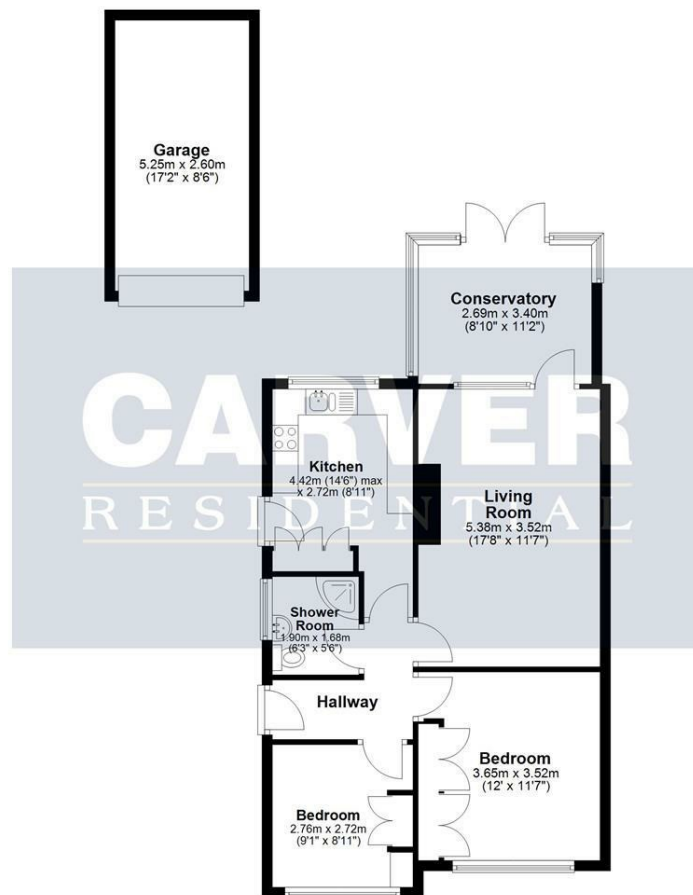

Total area: approx. 82.5 sq. metres (888.2 sq. feet)  
9 Garthorne Avenue, Darlington

Energy Efficiency Rating		
	Current	Potential
Very energy efficient - lower running costs		
(92 plus) <b>A</b>		<b>80</b>
(81-91) <b>B</b>		
(69-80) <b>C</b>		
(55-68) <b>D</b>		
(39-54) <b>E</b>		
(21-38) <b>F</b>	<b>57</b>	<b>80</b>
(1-20) <b>G</b>		
Not energy efficient - higher running costs		
England & Wales		EU Directive 2002/91/EC

We can search 1,000s of mortgages for you

It could take just 15 minutes with one of our specialist advisers:  
Call: 01325 380088. Visit: Any of our Offices. Online: [www.mortgageadvicebureau.com/carver](http://www.mortgageadvicebureau.com/carver)



Your home may be repossessed if you do not keep up repayments on your mortgage.  
There will be a fee for mortgage advice. The actual amount you pay will depend upon your circumstances.  
The fee is up to 1% but a typical fee is 0.3% of the amount borrowed

MAB 6202



These particulars do not constitute any part of an offer or contract. None of the statements contained in these particulars are to be relied on as statements or representations of fact and any intending purchaser must satisfy himself by inspection or otherwise to the correctness of each of the statements contained in these particulars. The vendor does not make or give, and neither Nick & Gordon Carver Residential or Commercial, Nick & Gordon Carver, nor any person in their employment has any authority to make or give any representation or warranty whatever in relation to this property



14 Duke Street, Darlington  
Co Durham, DL3 7AA  
01325 357807  
[sales@carvergroup.co.uk](mailto:sales@carvergroup.co.uk)

63 Dalton Way, Newton Aycliffe  
Co Durham DL5 4NB  
01325 320676  
[aycliffe@carvergroup.co.uk](mailto:aycliffe@carvergroup.co.uk)

41 Market Place, Richmond  
North Yorkshire, DL10 4QL  
01748 825317  
[richmond@carvergroup.co.uk](mailto:richmond@carvergroup.co.uk)

219 High Street, Northallerton  
North Yorkshire DL7 8LW  
01609 777710  
[northallerton@carvergroup.co.uk](mailto:northallerton@carvergroup.co.uk)

[www.carvergroup.co.uk](http://www.carvergroup.co.uk)